



# StarSCAN<sup>\*</sup>

## Versions

Current Release: **4.03**

*December 04, 2003*

Release 4.04 is set to arrive January 05, 2004. This release will include support for 2005 LX 300C. The networking pilot also will be available in release 4.04. This will make available wired networking and printing to those dealers participating in the pilot. Release 4.04 has improved keypad support, vehicle bus fault detection and

contains a virtual network client.

Release 4.03 arrived November 17, 2003. This release included updated ECU flash support for PCM and TCM.

Release 4.02 arrived October 13, 2003. This release included updated ECU flash support, support for USB keyboard, USB mouse, and network sup-

port for piloting purposes. Release 4.02 shipped in the Dodge Supplement Kit, which included the USB storage device and the USB adapter.

## Updating Your StarSCAN

Be sure to update your StarSCANS using the CD-ROM and USB memory device. It is imperative that you keep the StarSCAN up to date with the latest vehicle changes. See the detailed instructions for performing an update on

the <http://www.dcctools.com> website.

Don't forget: The USB memory device shipped with the updated kit in October. If you need to order more USB memory devices or USB adapters, you will

find links to on-line stores in the updated instructions found on the <http://www.dcctools.com> website.

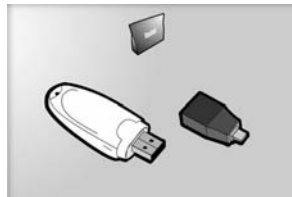

Latest News

### Inside this issue:

Version Information	1
Update Information	1
World Wide Web links	1

### Important Links:

- StarSCAN website: <http://www.dcctools.com>
- DealerCONNECT website: <https://dealerconnect.chrysler.com>
- STAR Center Online: <https://www.cpid.com/star/>